



Making Our Dream a Reality

- 
- **You've done a ton of hard work.**
 - **You've pledged your resources.**
 - **You're soooooo good. Ken Doyno is amazed at where we are on our expansion plans.**

Thank You!!



Capital Campaign

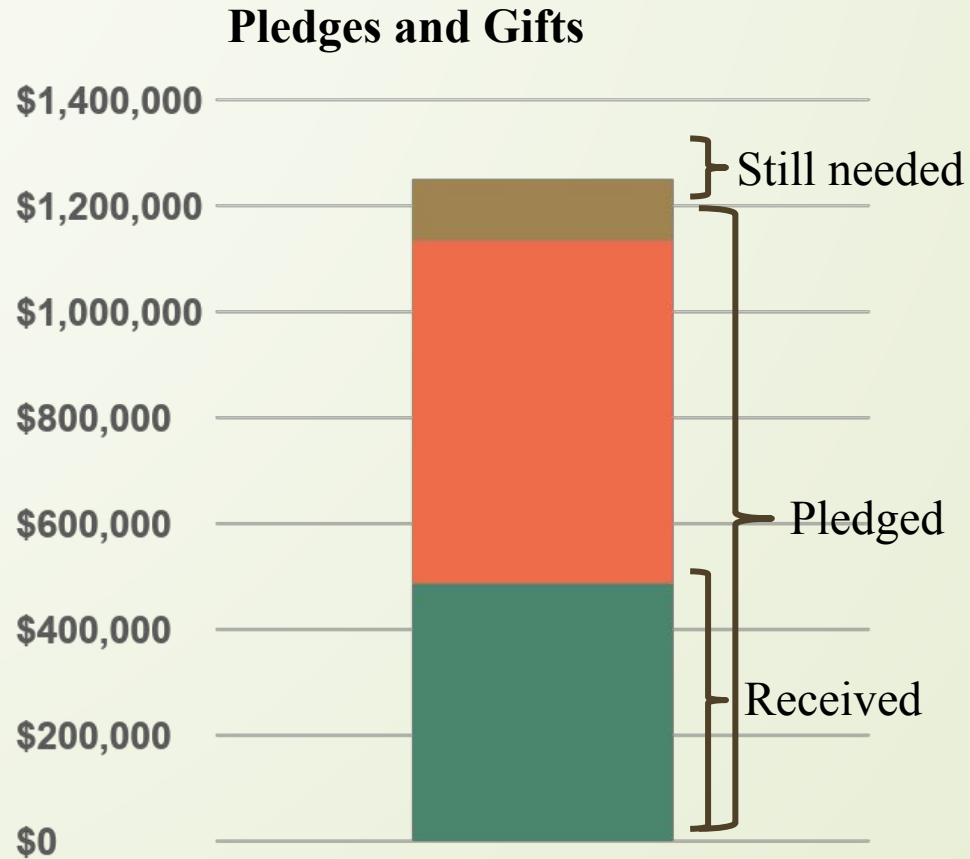

- **Goal: \$1,250,000**
- **Amount pledged: \$1,134,634**
- **Received to date: \$486,508 – 40% of our goal. Thank You!!**
- **Still needed: \$115,366**

- **2019 – quiet, planning**
- **2020 – the final push**

We dreamed about what we wanted

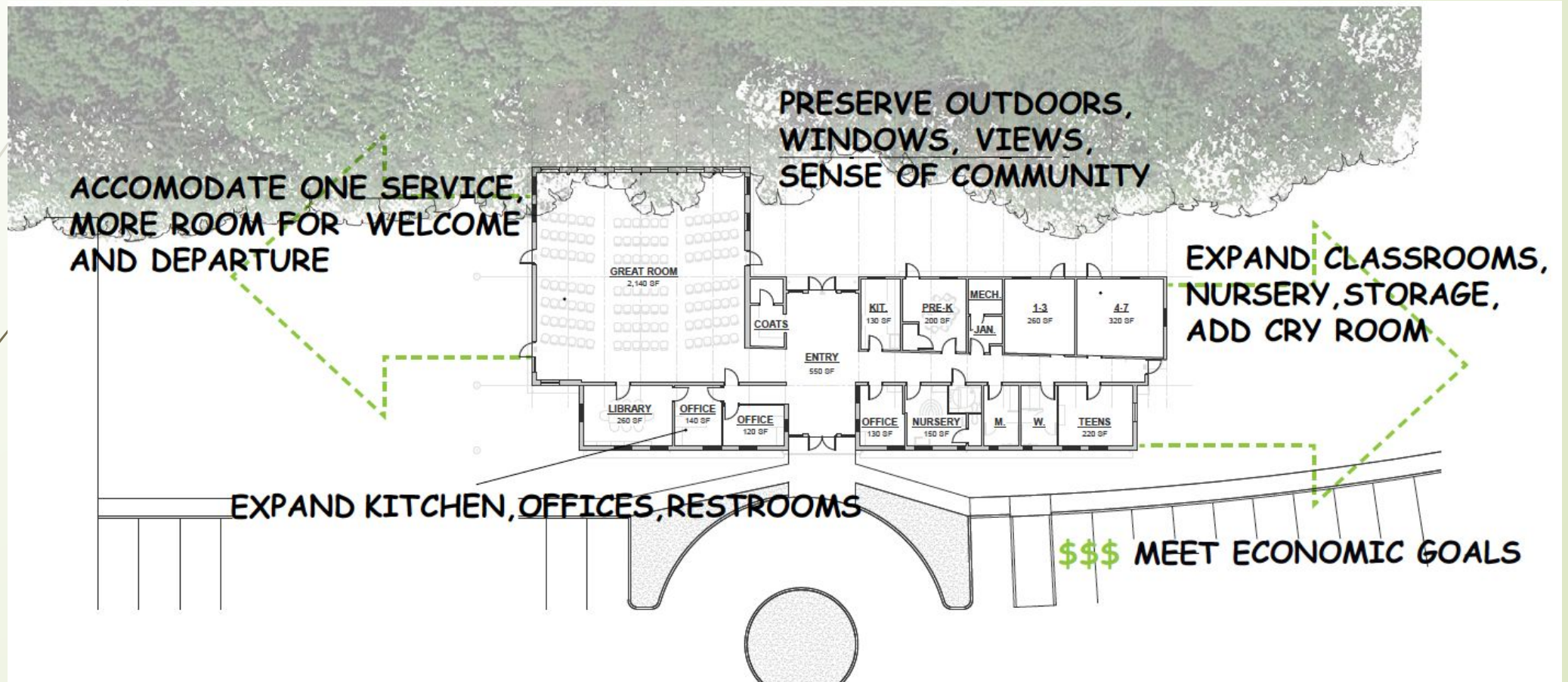

Looking at the numbers

- ❑ Overall budget goal: \$1,500,000
- ❑ Need \$375,000 (25%) for 'soft' costs – architect fees, furniture, equipment, permits, etc.
- ❑ Therefore, we have \$1,125,000 for construction

Total for construction	\$1,125,000
Site tie-in costs	\$125,000
Building construction budget	\$1,000,000
Cost per sq.ft.	\$225
Total projected area (sq.ft.)	~4,400

Looking at the numbers

\$1,000,000 for construction at \$225/sq.ft. gives us
about 4,400 sq.ft. expansion.

BUDGET AREA
4,400 GSF

*How would you
distribute this much
new construction?*



Uneven split with Sanctuary expansion

Great Room Addition

3,800 GSF
New Great Room
Kitchen
Restrooms
Cry Room
Storage

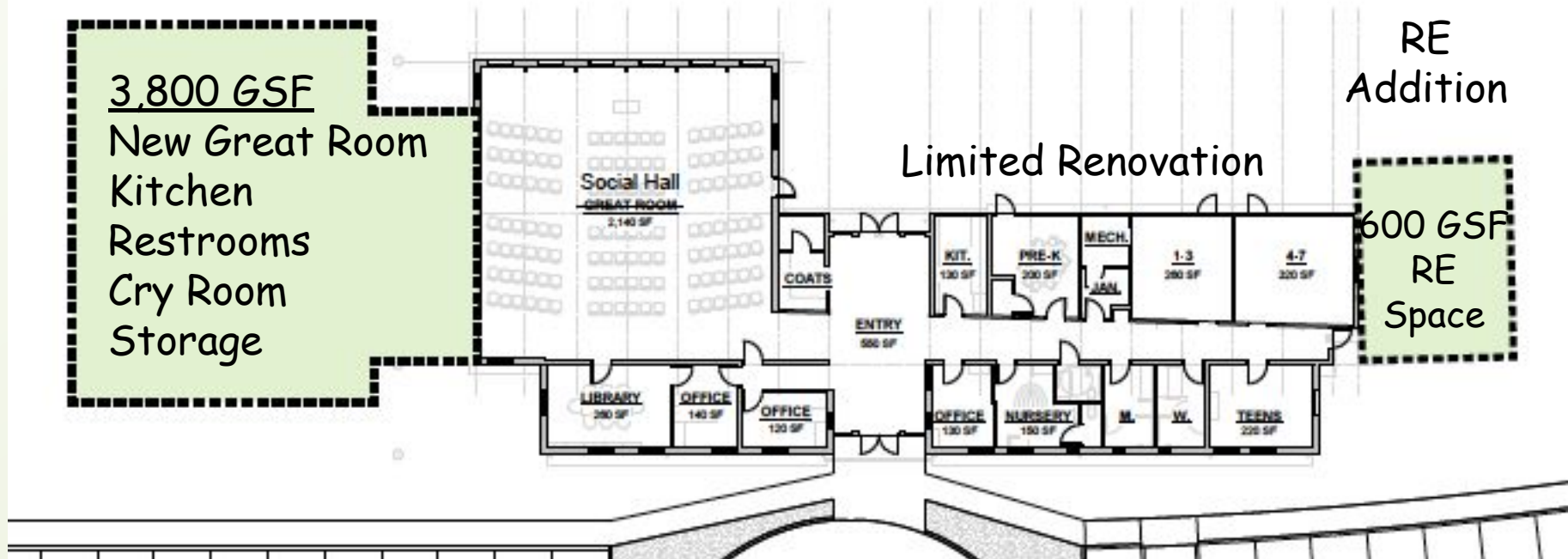

A more balanced approach

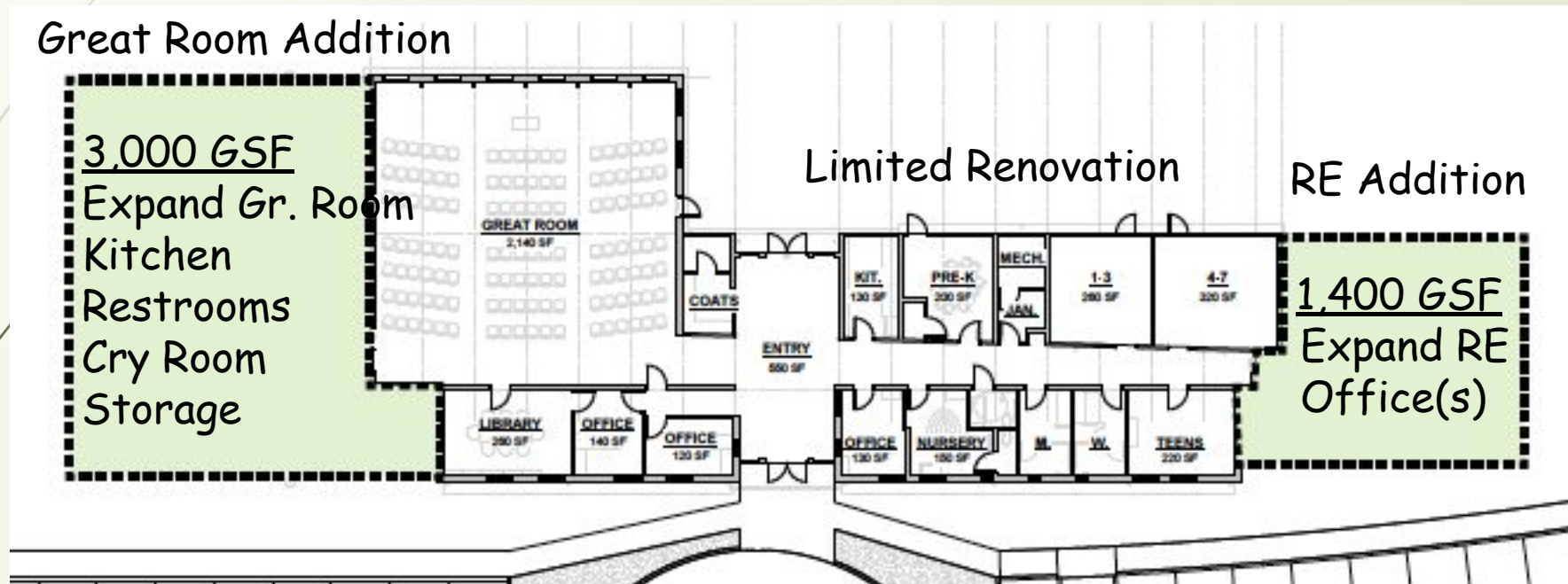

RE expansion and renovation

No Great Room Addition

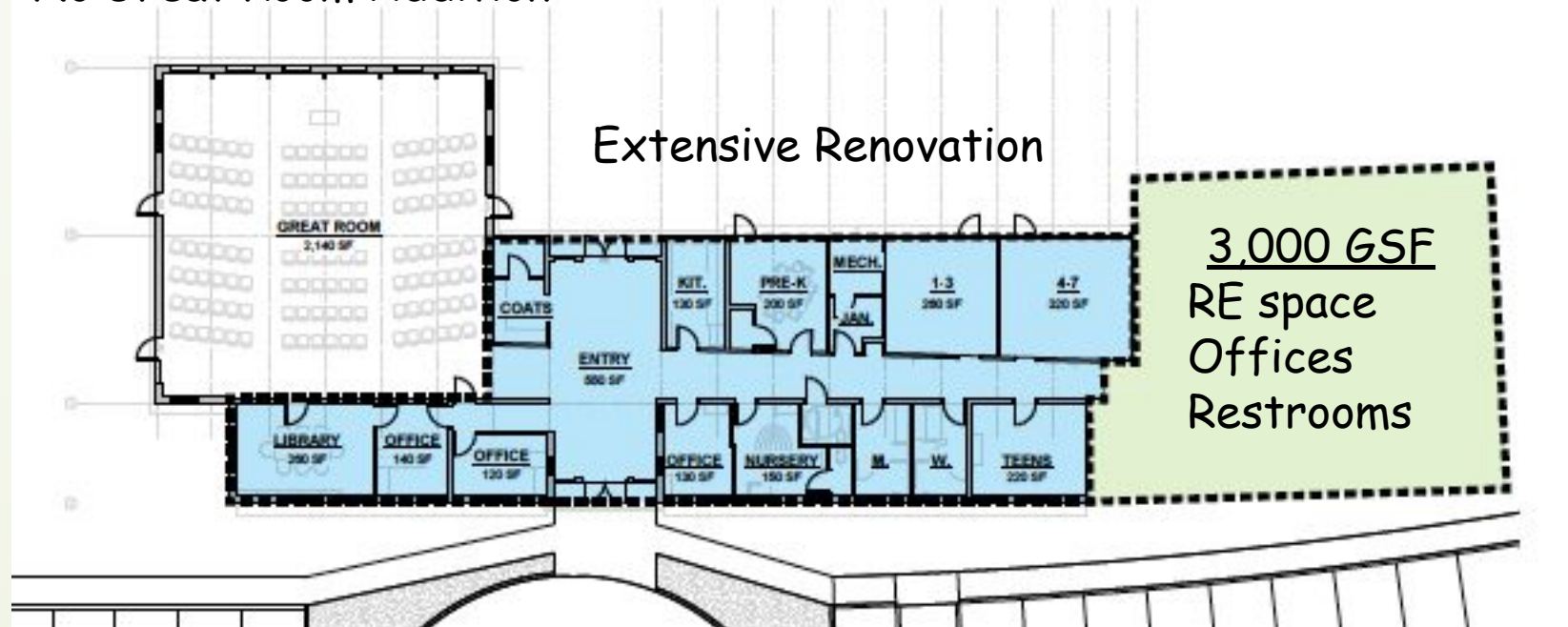

Large great room addition

Gathering Hall Addition

4,400 GSF

New Gathering Hall
Expand Great Room
Kitchen, Restrooms
Cry Room, Storage

Limited Renovation

No RE Addition

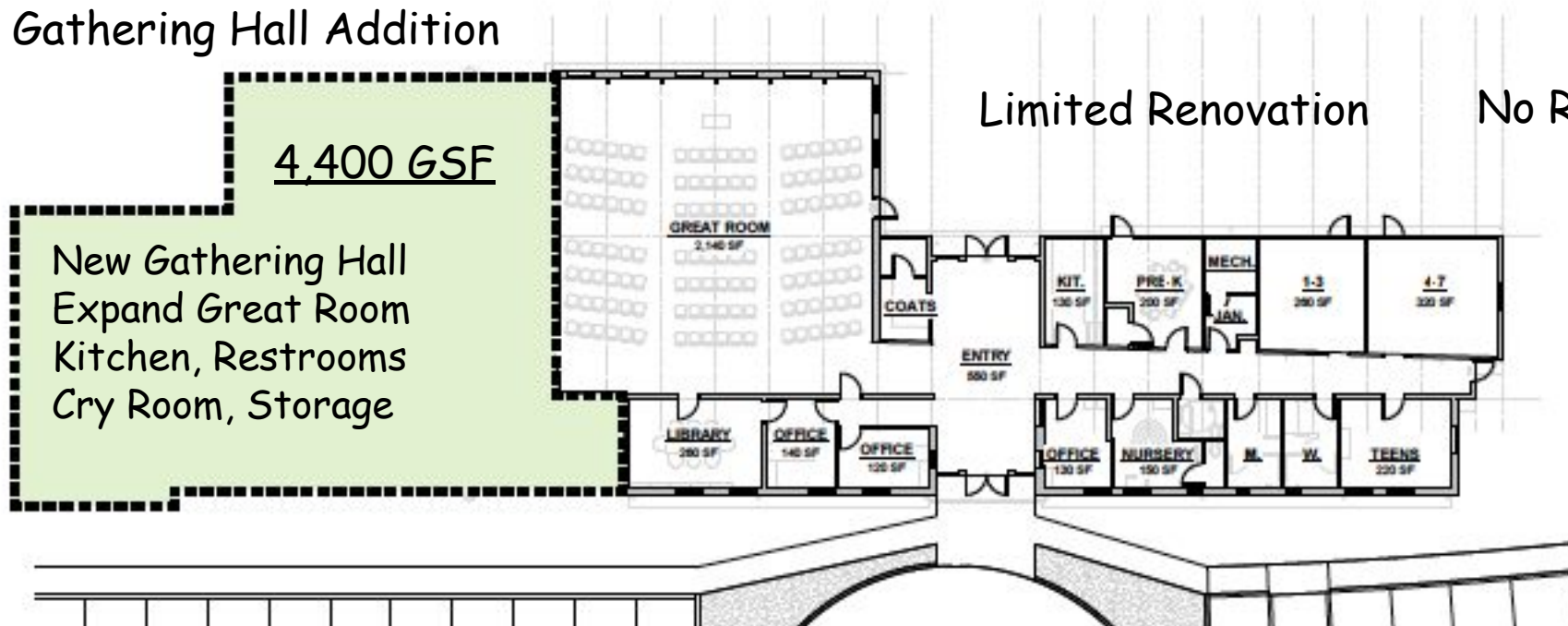

Green building

- ❑ In 2006, our current building was the first place of worship to receive LEED Gold certification.
- ❑ We're proud of the certification and are committed to living our Seventh Principle*
- ❑ The budget for facilities expansion was based on energy efficient addition(s) similar to our current building.
- ❑ The budget does not include certification, making the additions 'net zero', etc.
- ❑ These are possible, but will require a larger commitment from the fellowship.



You can't always get what you want...

- ❑ Expanded RE space with group meeting room
- ❑ Larger sanctuary for single service
- ❑ Social Space
- ❑ Larger, more functional kitchen
- ❑ More Bathrooms
- ❑ Renovated/additional offices, library
- ❑ More indoor storage
- ❑ Crying Room
- ❑ Welcoming Entry & Transition Spaces
- ❑ Green Building

**Haven't we talked
about this!?!**



**Yeah, but staying within budget
will require some adjustments....**

**What's a 'must have'? Where can
we compromise?**

To prioritize, we'll exercise...

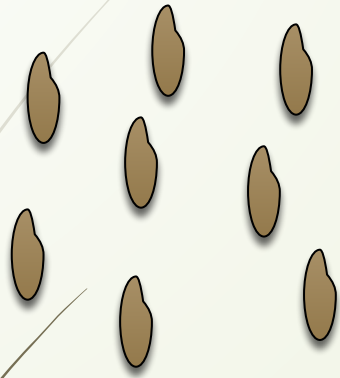

8 beans – 10 mason jars



- We heard you last year, as we dreamed about the ideal UUFWC building.
- Today, we want to think about what is most important for the **real** expansion!
- Nine building categories: RE, Sanctuary, social space, kitchen, bathrooms, transition spaces, offices, storage, crying room.
- Green building included as #10 because it will require resources.
- What do you think is/are most critical for the expansion? What might be expendable?

Balanced approach

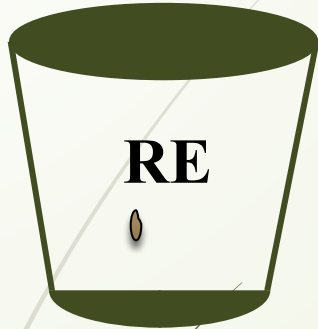

One service and bathrooms are all we need

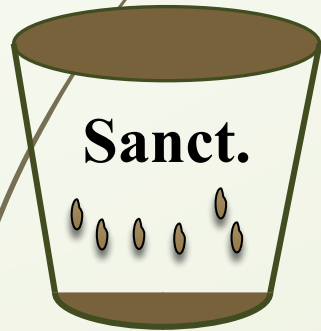
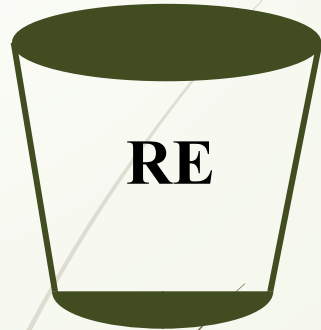

RE and the crowded entry/hallways are most important

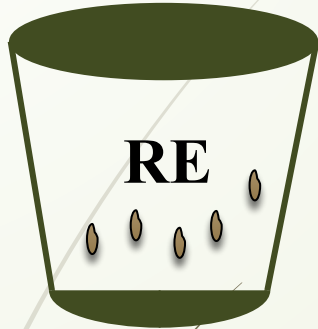

Coffee! & the minister's office shouldn't be a hallway

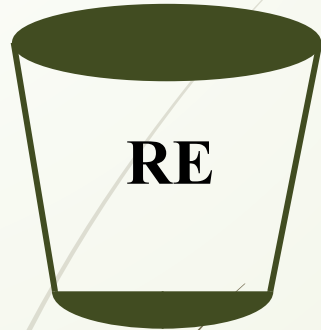

I don't care as long as it's green

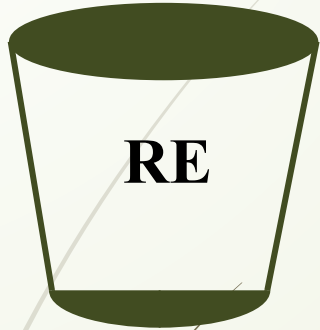



What will we do with this information?

- We'll count the beans and share that information with the congregation and RDC.**
 - RDC will use the information to develop program options that will be presented to the congregation in a month or so.**
 - We'll use that to reach consensus on the expansion footprint and shape**
- 

What else is on the horizon?

